

Central on Broadway

New Construction: Premier property with 18 new luxury residential condominiums on upper floors, resident parking garage underneath

Located in the heart of the busy South Boston retail and restaurant node, at signalized intersection of main area thoroughfares West Broadway, East Broadway, and Dorchester Street

ADT 11,735 at intersection

South Boston population growth: +25% since 2000

Population with bachelor's degree: +28% since 2000

Zoning: Multi-Family/Residential/Local Services

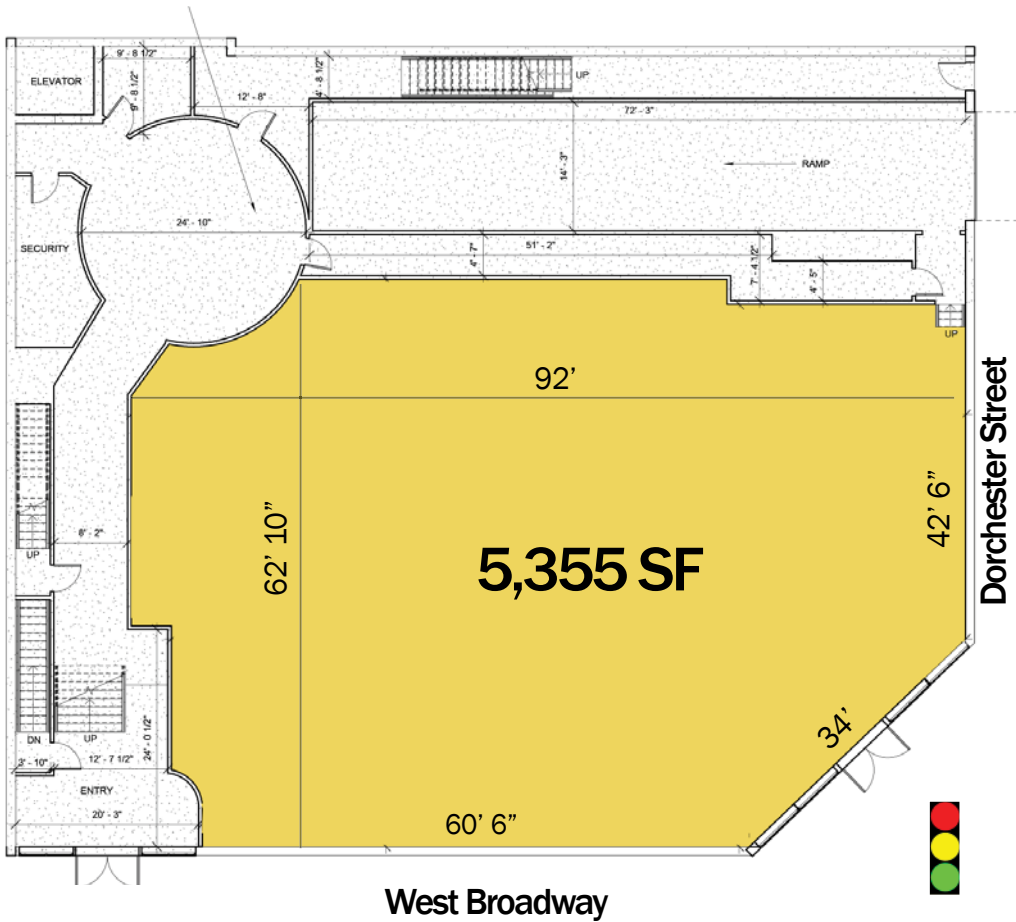





New Area Projects

- 1 CENTRAL ON BROADWAY**  
Mixed Use  
5,355 SF Available
- 2 CHANNELSIDE**  
1.1M SF Redevelopment  
Mixed Use
- 3 Iron Works:**  
2M SF Redevelopment  
Mixed Use
- 4 WASHINGTON VILLAGE**  
1M SF Redevelopment  
Mixed Use
- 5 ON THE DOT**  
3.8M SF Redevelopment  
Mixed Use
- 6 PAPPAS WAY**  
1.74M SF Redevelopment:  
Mixed Use
- 7 776 SUMMER STREET**  
1.68M SF Redevelopment:  
Mixed Use

Area Top Employers



South Boston		.25 mile	.5 mile	1 mile
POPULATION	37,383	5,534	20,445	30,551
NUMBER OF HH	18,649	2,754	10,284	20,756
AVERAGE HH INCOME	\$193,180	\$248,281	\$198,290	\$184,952
DAYTIME POPULATION	17,348	2,462	6,147	33,249







