

# Red Rock Plaza

1385 Washington St. (Route 1) No. Attleboro, MA 02760

# FOR LEASE



## 19,946 SF First Floor Retail (Subdividable)

Highly visible retail box located on heavily traveled Rt. 1 ADT 22,000  
Rt. 295 ADT 53,000

National co-tenants include Michael's, Savers, PetSmart

Center shares signalized access with Walmart Supercenter, Lowe's, Target, Best Buy, Dick's Sporting Goods

Facade and pylon signage available

Zoning: C60 (Commercial District)



## 7,246 SF Pad

Prominent pad facing Route 1 at signalized main entrance

Pylon signage available

No warranty or representation, expressed or implied, is made as to the accuracy of the information contained herein, and same is submitted subject to errors, omissions, change in price, rental or other conditions, or withdrawal without notice.

**CONTACT:** Don Mace  
Vice President of Retail Brokerage  
DMace@KeyPointPartners.com  
781.418.6243

Rob Grady  
Vice President of Retail Brokerage  
RGrady@KeyPointPartners.com  
781.418.6267

**KEYPOINT**  
PARTNERS  
KeyPointPartners.com



# Red Rock Plaza

1385 Washington St. (Route 1) No. Attleboro, MA 02760

# FOR LEASE

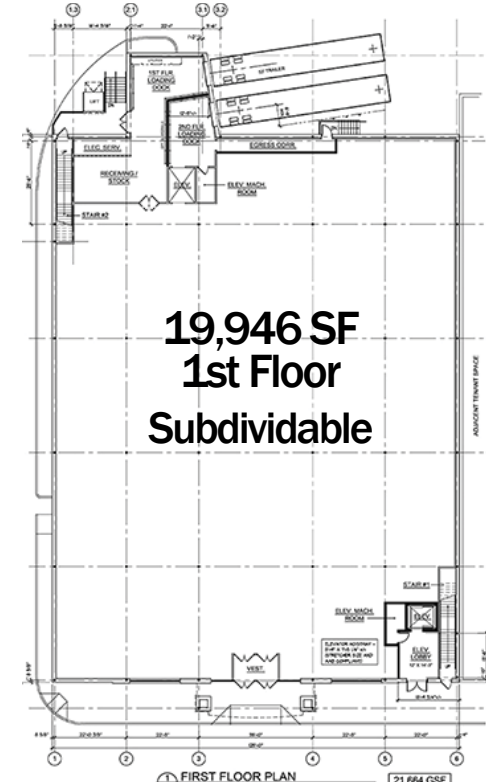

## OVERVIEW

First floor anchor space in prominent shopping center centrally positioned along the busy Route 1 retail corridor in North Attleboro, a regional trade area with 4.6 million square feet of retail space. Key nearby tenants include Marshalls, Ulta Beauty, Dick's Sporting Goods, DSW, BJ's Wholesale Club, Market Basket, Home Depot, Raymour & Flanagan, Burlington, and many more.

2024 DEMOGRAPHICS	3 Mile	5 Mile	7 Mile	ADDITIONAL INFO.	
POPULATION	48,998	185,153	294,080	TOTAL GLA	121,045 SF
NUMBER OF HH	19,510	74,476	119,277	PARKING	532 SPACES
AVERAGE HH INCOME	\$131,079	\$107,106	\$114,717	TRAFFIC COUNT	22,000 ADT (Rt 1) 53,000 ADT (Rt. 295)

No warranty or representation, expressed or implied, is made as to the accuracy of the information contained herein, and same is submitted subject to errors, omissions, change in price, rental or other conditions, or withdrawal without notice.

**CONTACT:** Don Mace  
Vice President of Retail Brokerage  
DMace@KeyPointPartners.com  
781.418.6243

Rob Grady  
Vice President of Retail Brokerage  
RGrady@KeyPointPartners.com  
781.418.6267



# Red Rock Plaza

# FOR LEASE

1385 Washington St. (Rt. 1) No. Attleboro, MA 02760



**CONTACT:** Don Mace  
Vice President of Retail Brokerage  
DMace@KeyPointPartners.com  
781.418.6243

Rob Grady  
Vice President of Retail Brokerage  
RGrady@KeyPointPartners.com  
781.418.6267

# Red Rock Plaza

# FOR LEASE

1385 Washington St. (Rt. 1) No. Attleboro, MA 02760

**Emerald Square Mall**  
JCPenney macys

**Red Rock Plaza**  
19,946 SF 1st Floor  
22,820 SF 2nd Floor  
7,246 SF Pad  
Michaels PETS MART SOUVERS  
Where Creativity Happens

**target**

**LAUNCH**  
Coming Soon

**BEST BUY**

**planet fitness**

**Guitar Center**

**ALICE**

**PLAY IT AGAIN SPORTS**

**FedEx Office**

**LL Flooring**  
LUMBER LIQUIDATORS

**Walmart SUPERCENTER**

**Ninety Nine**

**BLINDS TO GO**  
DIRECT FROM THE FACTORY

**T-Mobile**

**Vitamin Shoppe**

**JOANN**  
fabrics and crafts

**DICK'S**  
SPORTING GOODS

**DSW**

**Lowe's**  
Improving Home Improvement

**RAYMOUR & FLANIGAN**  
Furniture

**Chris Gasbarro's Fine Wine & Spirits**

**verizon wireless**

**OLD NAVY**

**Marshalls**

**five BELOW**

**LONGHORN**

**SKECHERS**

**Panera**

**LENSCRAFTERS**

**OSHKOSH Bigosh**

**CULTA**  
BEAUTY

**carter's**

**GameStop**

**ME Massage Envy**

**RAYMOUR & FLANIGAN**  
Furniture

**DOLLAR TREE**

**PATEL BROTHERS**  
"Celebrating Our Food...Our Culture"

**BJ'S**  
RESTAURANT BREWHOUSE

**53,000 ADT**  
Exit 1

**22,000 ADT**

**1**

**North Attleboro**

**Attleboro**

**1/2 Mile**

No warranty or representation, expressed or implied, is made as to the accuracy of the information contained herein, and same is submitted subject to errors, omissions, change in price, rental or other conditions, or withdrawal without notice.

**CONTACT:** Don Mace  
Vice President of Retail Brokerage  
DMace@KeyPointPartners.com  
781.418.6243

Rob Grady  
Vice President of Retail Brokerage  
RGrady@KeyPointPartners.com  
781.418.6267

